

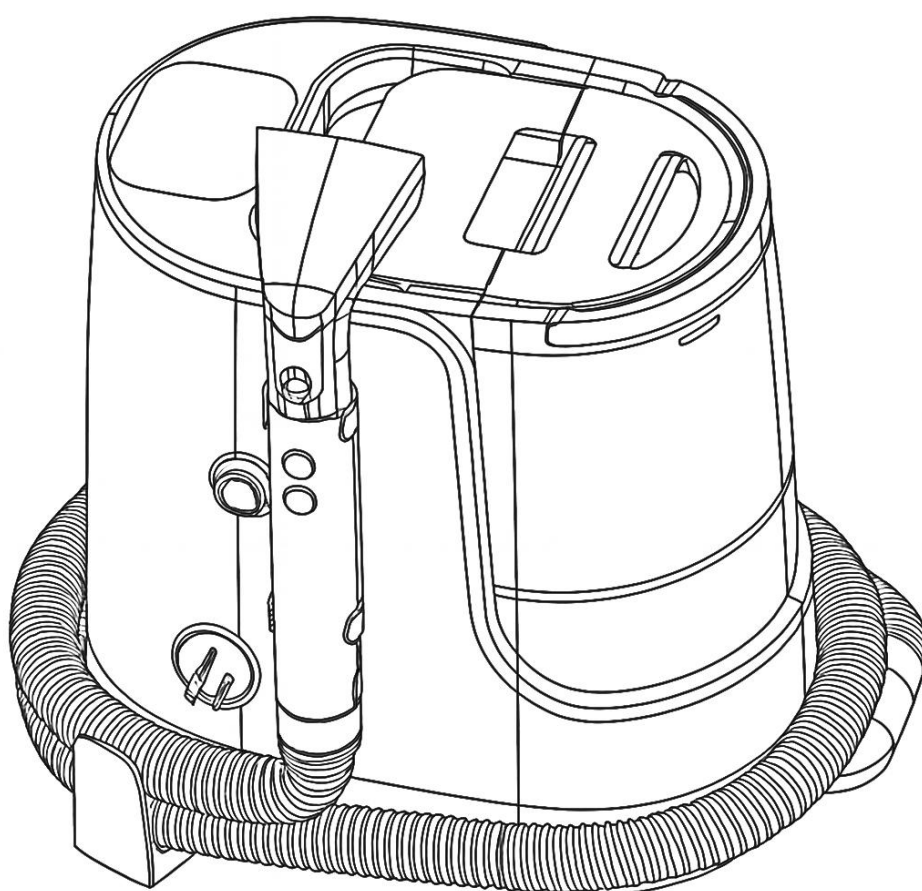

Electrolux



SPOT CLEANER
FLR00213

User Manual

Contents

Page No.

2	Contents
3	Reading and Storing the User Manual
3	Important Safety Instructions for Proper Use
7	Explanation of Symbols
8	What's in the Box
9	Description of Parts – The Main Unit
10	Description of Parts – The Control Panel
11	Description of Parts – The Accessories
12	Before First Use of Your Spot & Upholstery Cleaner
12	About Your Spot & Upholstery Cleaner
12	Attaching the Accessories
13	Filling the Clean Water Tank
14	Clean Water Tank Empty Indicator
15	Preparing the Carpet/Upholstery for Cleaning
17	Using Your Spot & Upholstery Cleaner
21	Hints & Tips for Using Your Spot and Upholstery Cleaner
22	Emptying and Cleaning the Dirty Water Tank
23	Cleaning and Maintenance of Your Spot and Upholstery Cleaner
23	Cleaning the Water Tank Filter
24	Cleaning the Floor Tools
24	Using the Self Clean Attachment
26	Cleaning the Outlet Filter
27	Storing Your Spot & Upholstery Washer
28	Technical Specification
28	The LED Colour Bargraph
29	Troubleshooting Guide
30	Customer Support
31	Recycling Information
31	Plug Wiring Information
32	FSC and Safety Marks
33	Notes
Back Page	Warranty Information

Reading and Storing the User Manual

Before using this product, please read through this manual carefully paying particular attention to the safety instructions. Failure to do so may result in personal injury or damage to the product. Carefully save this instruction manual for future reference. Ensure the user manual is included when passing the product on to any third parties.

Important Safety Instructions for Proper Use

When using electrical appliances, basic safety precautions should always be followed.

Only use the product as described in this user manual. Any other use is considered improper and may result in damage to property or persons.

The manufacturer or vendor cannot be held liable for damages or injury incurred through improper or incorrect use.

- Read and familiarise yourself with all operating instructions before using this Spot Cleaner.
- Before plugging your unit into the mains, visually check that the unit is intact and has not suffered any transit damage.
- Check that the voltage indicated on the data plate corresponds with that of the local network before connecting the appliance to the mains power supply.
- This appliance can be used by persons with reduced physical, sensory or mental capabilities or lack of experience and knowledge if they have been given supervision or instruction concerning use of the appliance in a safe way and understand the hazards involved.

Important Safety Instructions for Proper Use

- Children shall not play with the appliance.
- Keep the appliance and its cord out of reach of children less than 8 years when it is energised or cooling down.
- **DO NOT** immerse the appliance or its cord in water or any other liquids.
- **DO NOT** leave the appliance unattended during use.
- **DO NOT** leave the appliance unattended whilst connected to the mains supply.
- **DO NOT** use this appliance outdoors.
- It is imperative to unplug the power cord after the appliance has been used, before it is cleaned and whilst being repaired.
- Repairs to electrical appliances should only be performed by qualified personnel. Improper repairs may place user at serious risk.
- **DO NOT** operate this appliance with a damaged plug or cord, after a malfunction or after being dropped or damaged in any way.
- Regular, periodic checks should be carried out on the mains cable to ensure no damage is evident. Should there be any signs of damage the appliance should not be used.
- If the power cable is damaged, it should only be replaced by qualified personnel in order to avoid a hazard.
- **DO NOT** allow the mains cable to hang over sharp edges or come in contact with hot surfaces.
- **DO NOT** run the mains cable under carpets, rugs, etc.
- The appliance is not to be used if it has been dropped, if there are visible signs of damage or it is leaking.

Important Safety Instructions for Proper Use

- The plug must be removed from the socket outlet before the reservoir is filled with water or the waste water tank emptied.
- The filling aperture must not be opened during use.
- Allow the unit to cool before storage.
- Before cleaning, disconnect the appliance from the mains supply and allow to cool.
- This appliance is intended for household use only and should not be used for industrial purposes.
- **DO NOT** use any accessories or attachments with this appliance other than those supplied or recommended by supplier.
- **DO NOT** use this appliance for anything other than its intended use.
- **DO NOT** push objects into any openings as damage to the appliance and/or electric shock may occur.
- Unplug after each use. Grasp the plug, not the cord.
- **DO NOT** pull or carry the appliance by the electrical cord.
- **Caution:** Always wear suitable shoes when using the Spot Washer and when changing accessories, do not wear slippers or open toed footwear.
- Ensure fingers and other objects are never placed in any part of the Spot Cleaner. Clothing or hair may become trapped if the Spot Cleaner is used improperly.
- Keep hair, loose clothing, jewellery, fingers and all parts of the body away from openings and moving parts.
- Keep all air vents clear and free of dust, lint, hair and anything else that may reduce airflow.
- Avoid directing the appliance towards naked flames as the air discharged may extinguish gas fires or pilot lights and may disturb ashes in open fires.

Important Safety Instructions for Proper Use

- Never operate the appliance without water.
- Never fill the water tanks past the maximum level mark.
- **DO NOT** run the Spot Cleaner over hot ashes or lit cigarettes, etc.
- **DO NOT** use the Spot Cleaner without the water tanks fitted.
- **DO NOT** run the Spot Cleaner over any large or broken objects such as glass.
- **DO NOT** run the Spot Cleaner over anything that is burning or smoking such as cigarettes, matches or hot ashes.

Explanation of Symbols

The following warning symbols or words are used in this instruction manual:

	<p>Products labelled with UK Conformity Assessment identifies products conforming to UK statutory requirements</p>
	<p>Products labelled with this symbol conform to applicable provisions of the European Economic Area.</p>
	<p>You should now recycle your waste electrical goods and in doing so help the environment. This symbol means waste electrical products at the end of their useful life should not be disposed of with normal household waste and not sent to landfill. Please ensure it is taken to a suitable facility for disposal. Check with your Local Authority or retailer for recycling advice or visit www.recycle-more.co.uk or www.weeeireland.ie enter your postcode to find out your nearest recycling site.</p>
	<p>This symbol indicates that the supply uses an alternating current mains supply.</p>
	<p>This product is a class I product and therefore requires an earth connection.</p>
 WARNING!	<p>This designates a hazard with moderate risk, which may result in severe injury or damage to the product if not adhered to.</p>



Electrolux

What's In the Box

- Spot Cleaner Main Unit
- Wide Nozzle Tool
- Washer Tool
- Focus Brush Tool
- Self Cleaning Tool



Description of Parts – The Main Unit

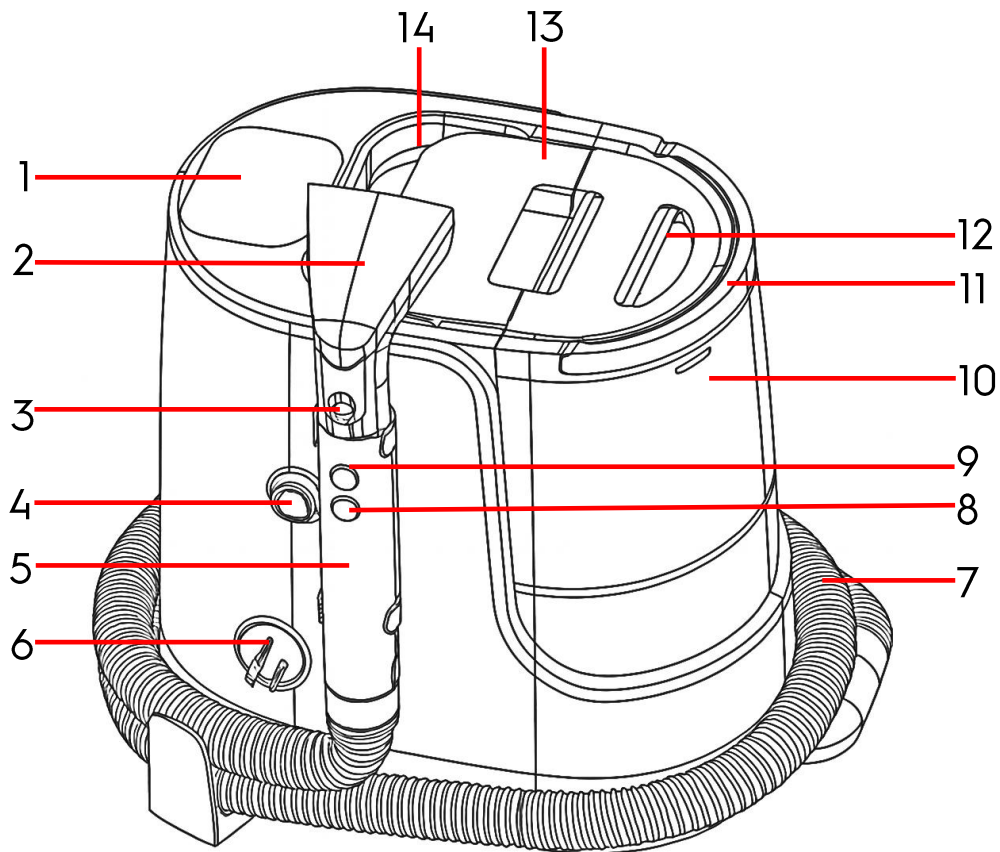

1. Control Panel.
2. Accessory Tool Position (24, 25 & 26).
3. Tool Release Button.
4. Mains Cable Rewind Button.
5. Multitool.
6. Mains Plug/Cable.
7. Flexible Hose.
8. Spray On/off Button.
9. Vacuum On/off Button.
10. Dirty Water Tank.
11. Dirty Water Tank Carrying Handle.
12. Dirty Water Tank Lid.
13. Clean Water Tank.
14. Carry Handle.

Description of Parts – The Control Panel

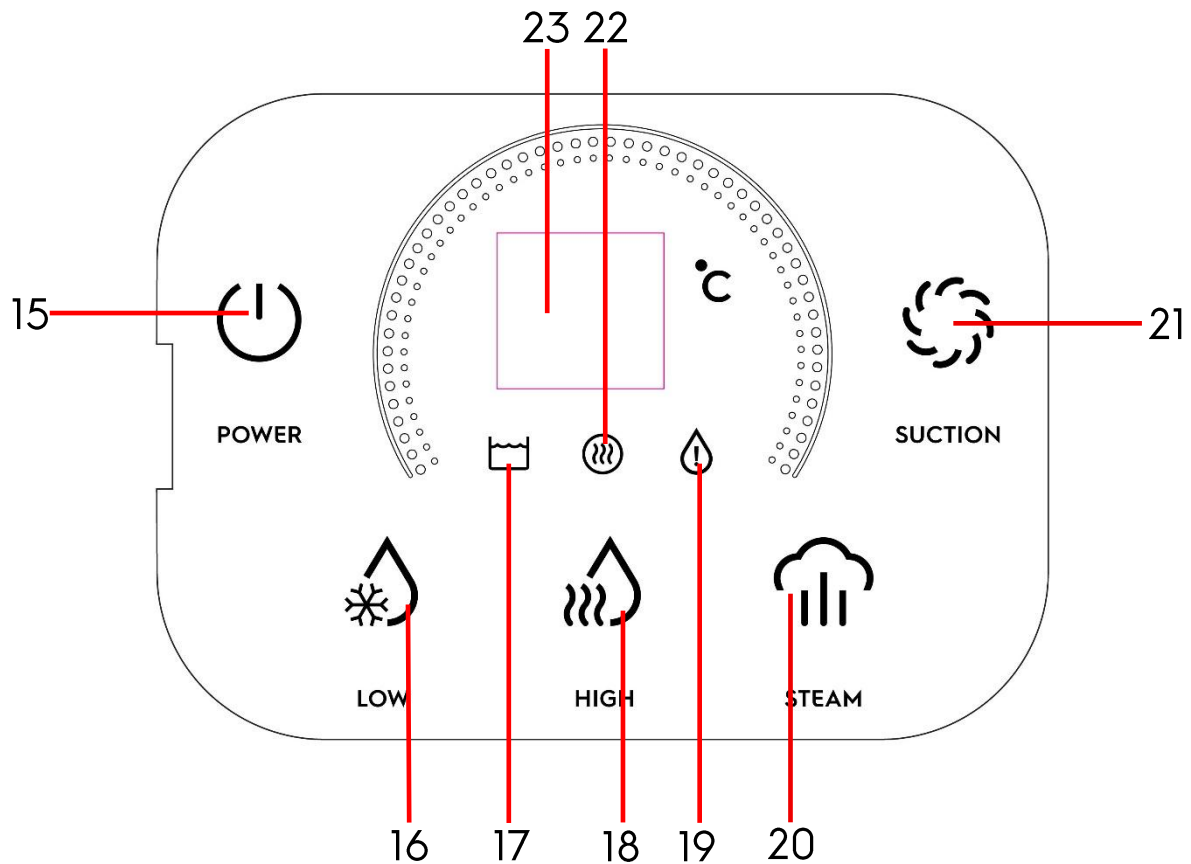

- 15. Standby Button.
- 16. 'LOW' Warm Cleaning Mode Button.
- 17. Dirty Water Tank Full Indicator.
- 18. 'HIGH' Hot Water Cleaning Mode Button.
- 19. Clean Water Tank Empty Indicator.
- 20. 'STEAM' Clean Mode Button.
- 21. High/Low Suction Button
- 22. Preheat Indicator
- 23. Water Temperature Display

Description of Parts – The Accessories

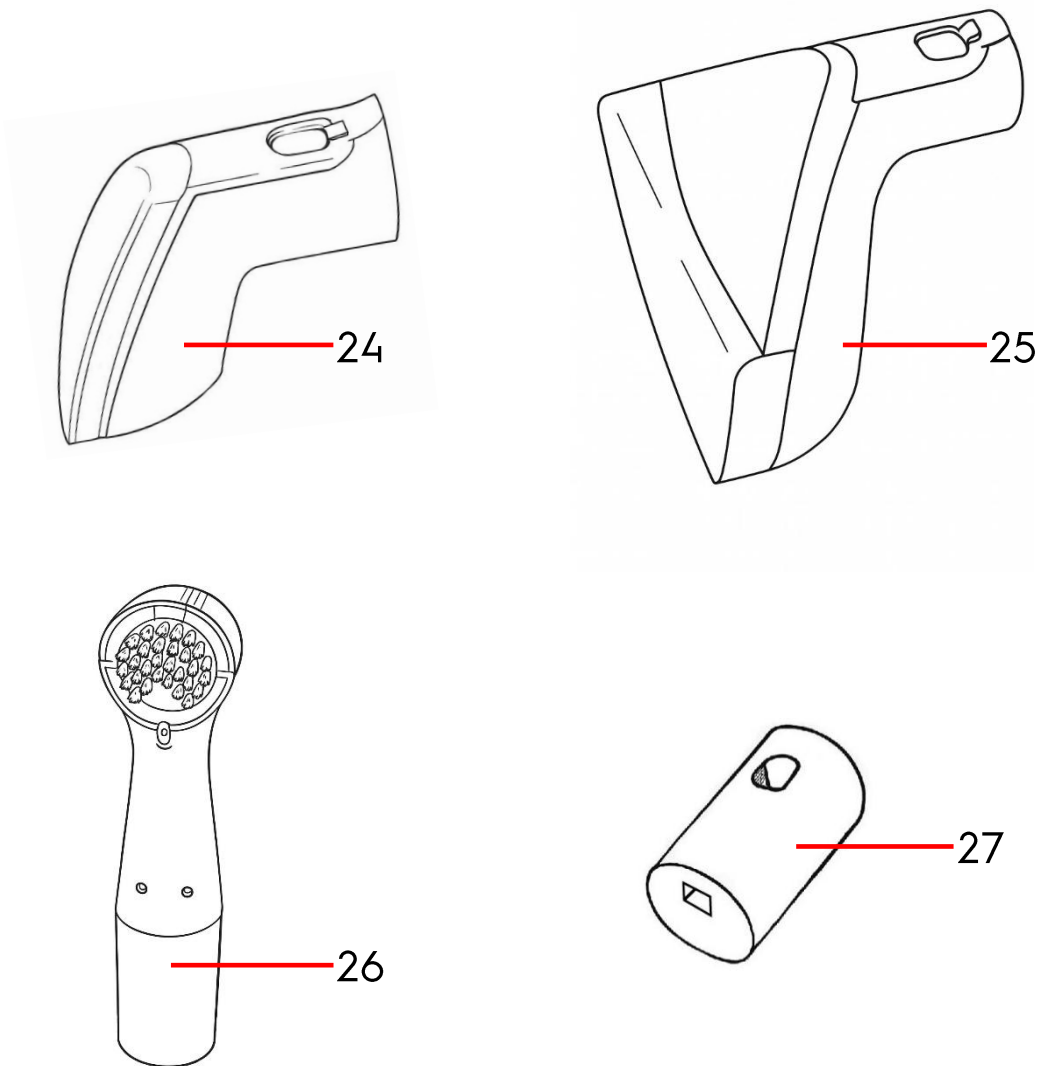

- 24. Washer Tool.
- 25. Wide Nozzle Tool.
- 26. Focus Brush Tool
- 27. Self Cleaning Tool.

Before First Use of Your Spot & Upholstery Cleaner

- Before use, retain all packaging until all the parts are present against the parts list – see **Description of Parts** above.
- Take care whilst opening the carton as a sharp blade may damage the product.
- After which discard packaging responsibly.

About Your Spot & Upholstery Cleaner

- This Spot Cleaner is designed to clean small areas of household fabric surfaces, such as patches of carpets and upholstery, it is not suitable for use as a conventional vacuum cleaner.
- Do not use the Spot Cleaner on other materials.
- Only use the Spot Cleaner with tap water or purified/distilled water.
- Ensure that water does not enter electrical parts.

Attaching the Accessories

Before use, unravel the **Flexible Hose** (7) from around the cleaner and choose the cleaning tool suitable for the cleaning job to be done.

Push the chosen tool (24, 25 or 26) onto the end of the **Multitool** (5) until it clicks into place as shown below:

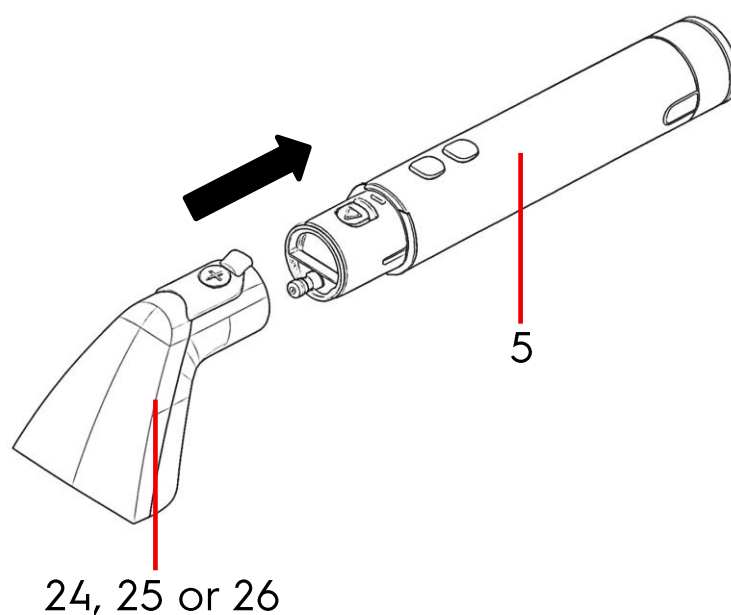

Filling the Clean Water Tank (13)

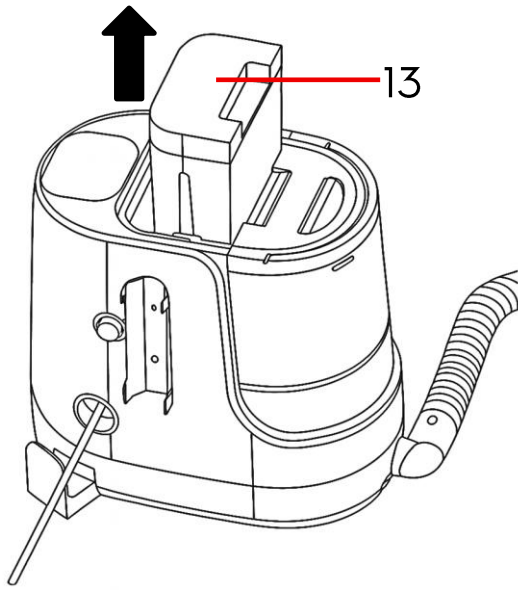

1. Grasp the handle on the top and lift the **Clean Water Tank (13)** straight up out of the Spot Cleaner.

2. Lay the **Clean Water Tank (13)** on its side and pull out the **Filling Cap** (a - arrowed right) and fill the tank with water.*

*It is strongly recommended that Filtered/Demineralised water is used in hard water areas to maintain the efficiency and prolong the life of the product.

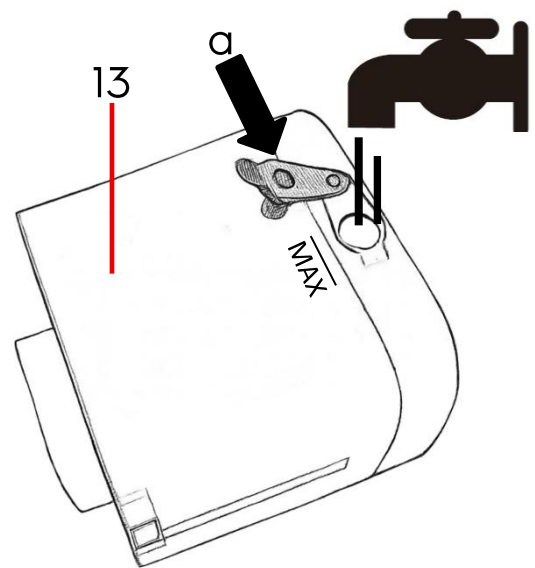

3. Fill the tank with water (max. 40°C), ensure that the level is not above the 'MAX' mark on the side of the tank when the tank is vertical.

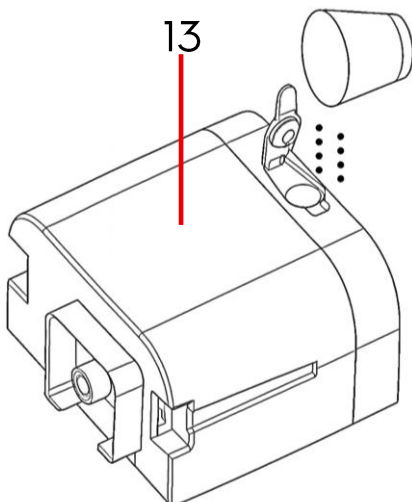

4. For more stubborn stains, add detergent to the **Clean Water Tank (13)**. Follow the manufacturers guidelines for the quantity of detergent to add to the tank water capacity which is one Litre.

Filling the Clean Water Tank (13)

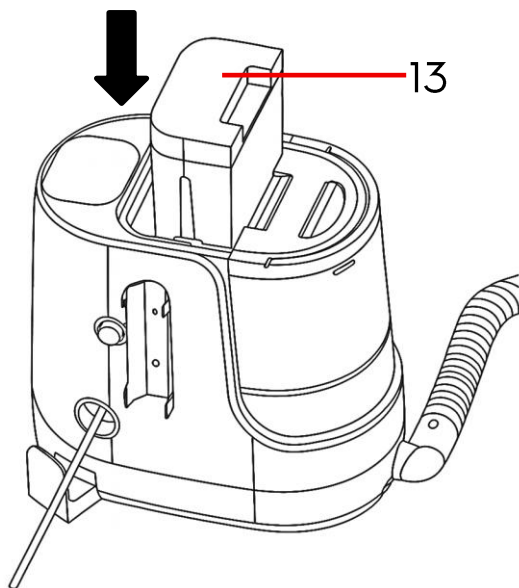

5. Carefully replace the **Clean Water Tank (13)** into the Spot Cleaner.

⚠ WARNING!

DO NOT overfill the tank as this will cause spillage/leakage.

DO NOT operate the Spot Cleaner with an empty **Clean Water Tank (13)** or the **Dirty Water Tank (10)** not fitted, otherwise permanent damage may occur to the appliance.

The Clean Water Tank Empty Indicator (19)

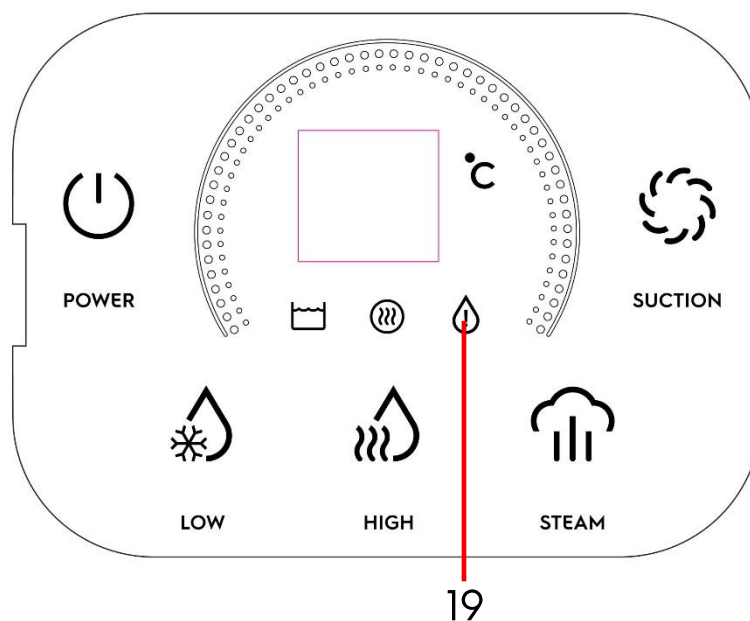

If the **Clean Water Tank Empty Indicator (19)** flashes red the **Clean Water Tank (13)** requires filling. Once filled the **Clean Water Tank Empty Indicator (19)** will go out.

Preparing the Carpet/Upholstery for Cleaning

Before cleaning, dampen a white cloth and rub the cloth gently over a small test area on the carpet or upholstery to be cleaned and check for any colour bleeding. If the cloth remains clean, it should be safe to continue.

 **WARNING! DO NOT** use this Spot Cleaner as a conventional dry vacuum cleaner as this will damage the appliance.

Preparing the Carpet/Upholstery for Cleaning

1. Ensure the **Dirty Water Tank** (10) is in place.
2. Pull the **Mains Cable** (6) from the side of the unit and stop pulling the cable once the yellow mark on the cable shows. Do not pull the cable past the red mark.

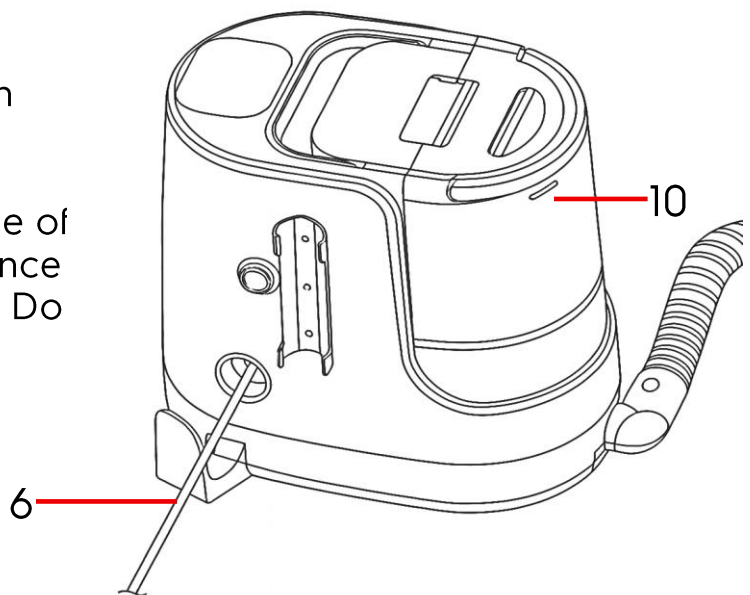
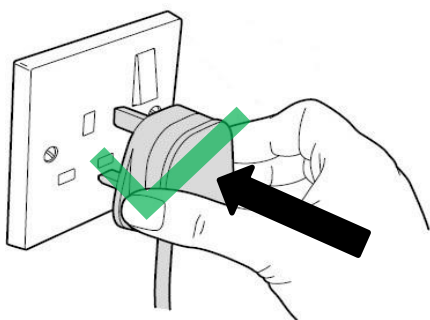

3. Insert the **Mains Plug** (6) into the nearest mains socket and switch the socket on (if applicable).

4. Once the **Mains Plug** (6) has been inserted the **Standby Button** (15) on the **Control Panel** (1) will illuminate:

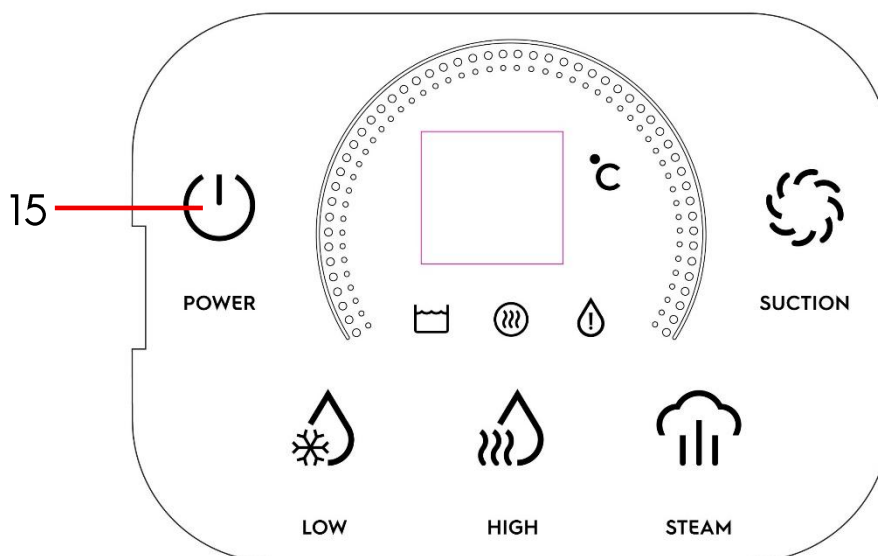

Using Your Spot & Upholstery Cleaner

Touch the **Standby Button** (15)  to power up the Spot and Upholstery Cleaner, the **Control Panel** (1) will illuminate. **NB** touch the **Standby Button** (15) for three seconds to power the unit down.

Powering Up

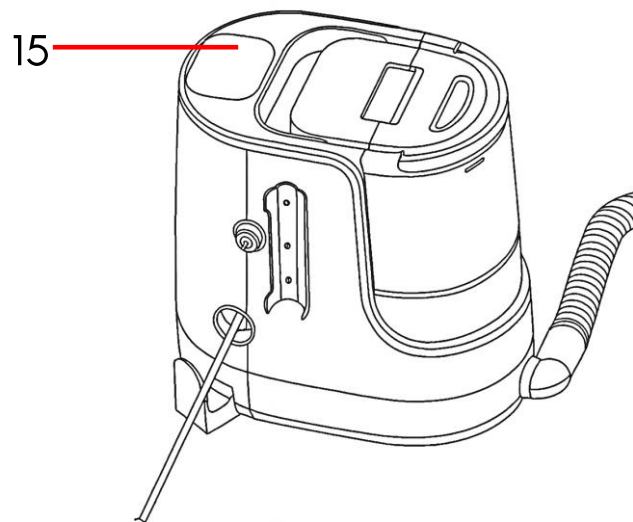

Selecting the Cleaning Mode

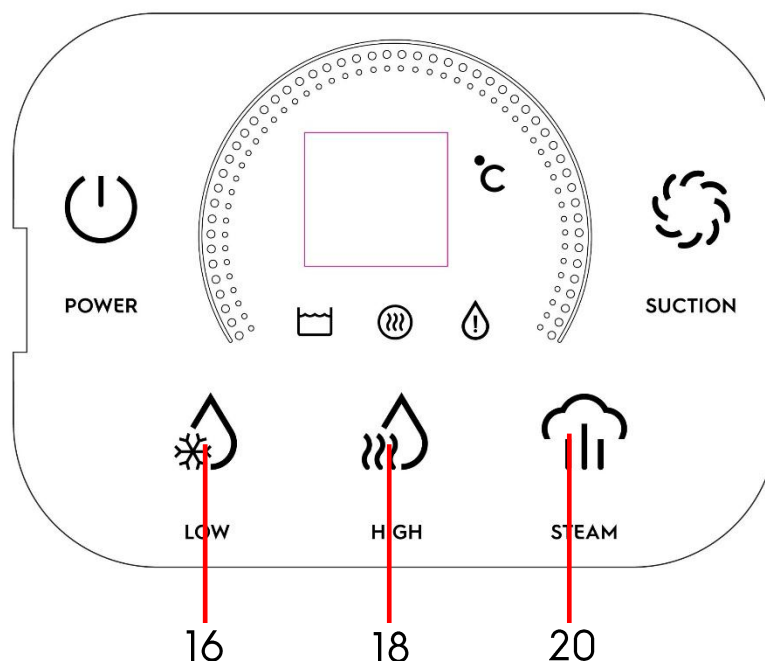

1. Touch the '**LOW**' Button (16) to select the warm water cleaning mode.
2. Touch the '**HIGH**' Button (18) to select the hot water cleaning mode.
3. Touch the '**STEAM**' Button (20) to select the steam cleaning mode.

Using Your Spot & Upholstery Cleaner

Using the Steam Mode

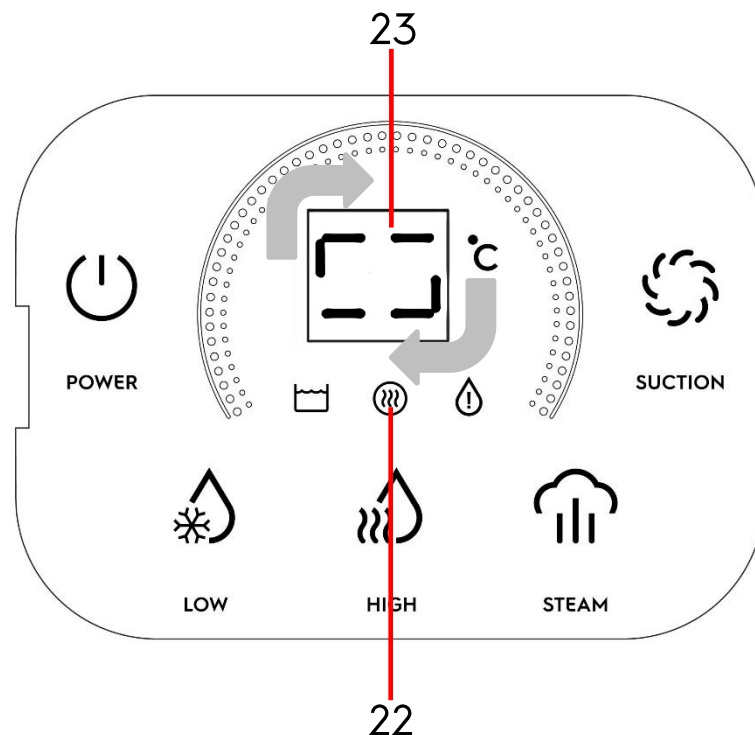

After selecting the Steam Cleaning mode, the cleaner will enter pre-heat mode.

Pre-heat mode is shown by the **Water Temperature Display** (23) which will cycle in the direction of the arrows shown above and the **Preheat Indicator** (22) will flash red.

Once the **Water Temperature Display** (23) has stopped flashing and showing 99°C and the **Preheat Indicator** (22) has also stopped flashing, pre-heat is complete and the Spot Cleaner is ready to steam clean.

Using Your Spot & Upholstery Cleaner

Switching the Vacuum On and Off

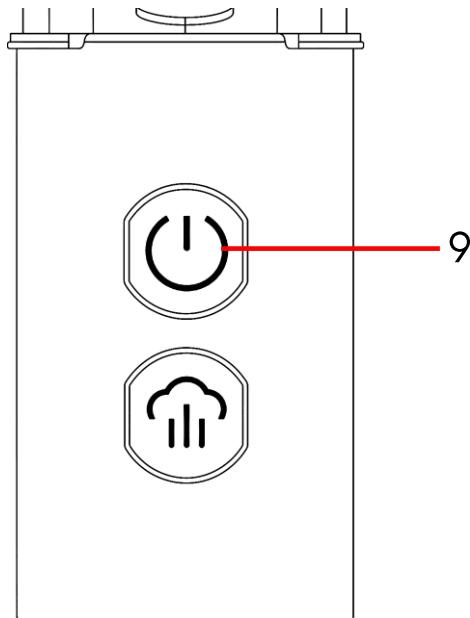

1. Press the **Vacuum On/off Button** (9) to operate the vacuum. The LED indicator in the button will illuminate.
2. Press the **Vacuum On/off Button** (9) again to switch the vacuum off.

NB The Spot Cleaner will power down over several seconds and LED in the **Vacuum On/off Button** (9) will flash whilst the cleaner powers down.

Switching the Spray On and Off

3. Whilst the vacuum is running, press and hold the **Spray On/off Button** (8) to release the Cold/Hot/Steam spray (whichever is selected). The LED indicator in the button will flash. Release the button to stop spraying.

NB after the **Spray On/off Button** (8) has been released, there will be a short delay whilst the excess water/steam is expelled from the Flexible Hose after which the spray will stop.

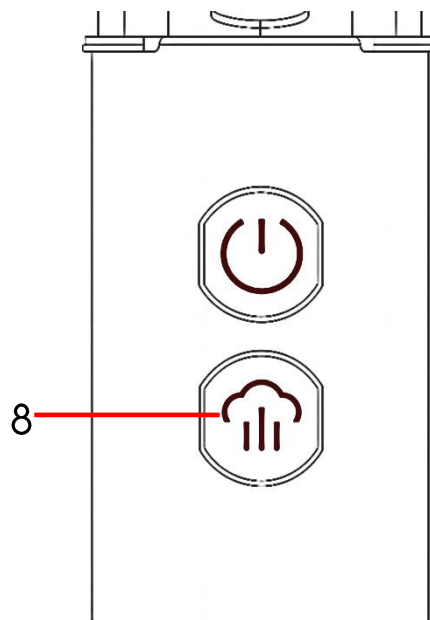

Note on Switching Modes

If the cleaning mode is changed during use, the Spot Cleaner will turn off the previous cleaning mode. Select the new cleaning mode and press the **Vacuum On/off Button** (9) on the **Multitool** (5) to restart the Spot Cleaner.

Using Your Spot & Upholstery Cleaner

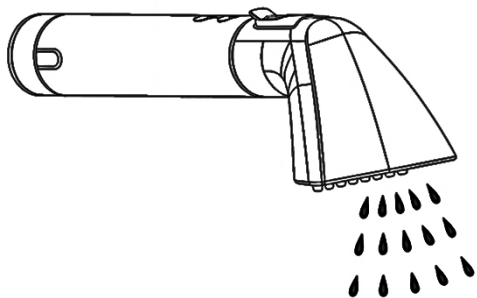

1. Move the spray over the area to be cleaned.
2. Once the area is sufficiently saturated, place the **Accessory Tool** (2) evenly and firmly against the carpet or upholstery. Pull the handle slowly towards you, keeping it pressed against the material to vacuum the dirty water which will be collected in the **Dirty Water Tank** (10).

3. Repeat the above steps if necessary if the spot requires further cleaning.

NB Whilst using the Spot Cleaner, a little condensation will be expelled from the **Accessory Tool** (2), hold the **Multitool** (5) in free air until the water/steam is emitted.

⚠ WARNING! Be careful whilst using this Spot Cleaner due to a scalding hazard.

Changing the Suction Modes

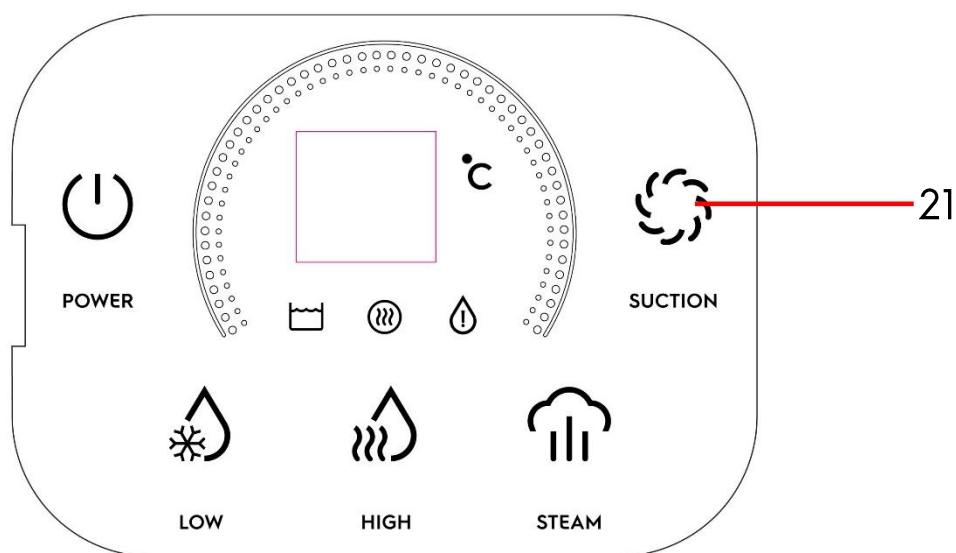

Touch the **Suction Button** (21) to select between high and low suction modes.

Hints & Tips for Using Your Spot and Upholstery Washer

Spraying

Do not spray water continually in the same place, as the water will quickly be absorbed after spraying. If the water penetrates too deeply and is not sufficiently re-absorbed, mildew could start to form.

Stubborn Marks

If the mark is heavily soiled, use a concentrated carpet cleaning solution readily available from most DIY stores and online sites prior to using the spot washer. Follow the Carpet Cleaning Solution manufacturers guidelines before using the solution on your carpet.

Emptying and Cleaning the Dirty Water Tank (10)

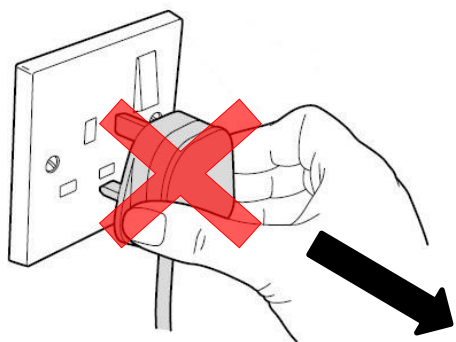
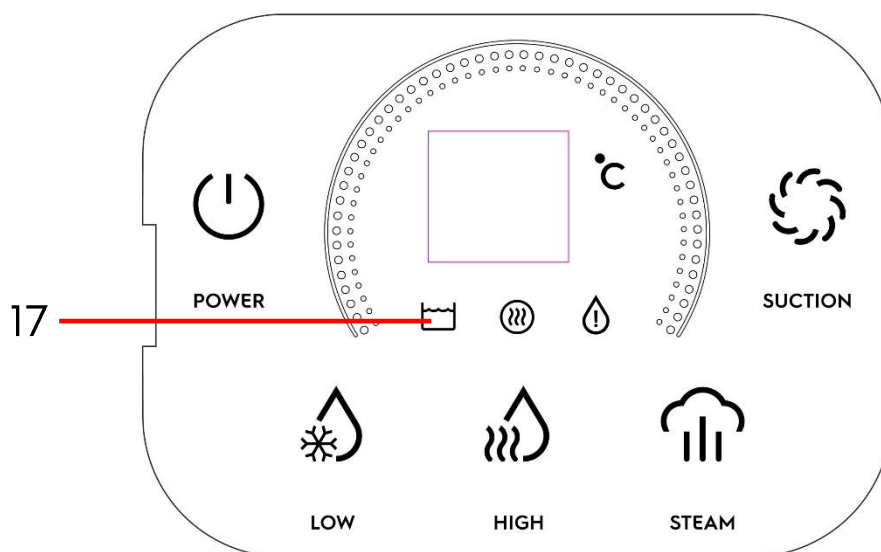

If the **Dirty Water Tank Full Indicator (17)** flashes red, the **Dirty Water Tank (10)** will require emptying and cleaning.

Ensure the mains plug is removed from the socket before emptying the **Dirty Water Tank (10)** as below:

NB if you continue to use the cleaner past the 'MAX' mark the Spot Cleaner will automatically stop cleaning.

Emptying and Cleaning the Dirty Water Tank (10)

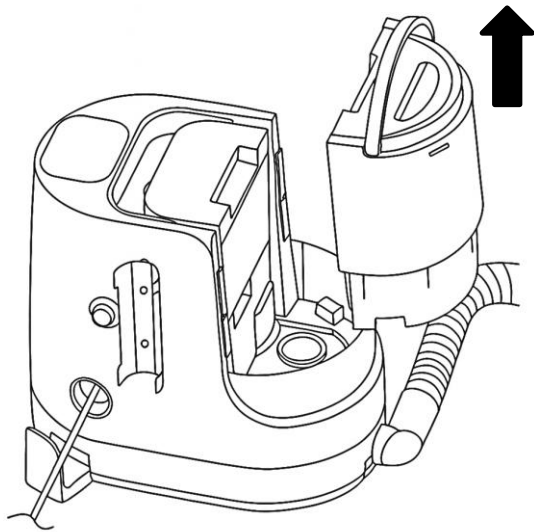

1. Lift the **Dirty Water Tank (10)** by its handle up clear of the Spot Cleaner

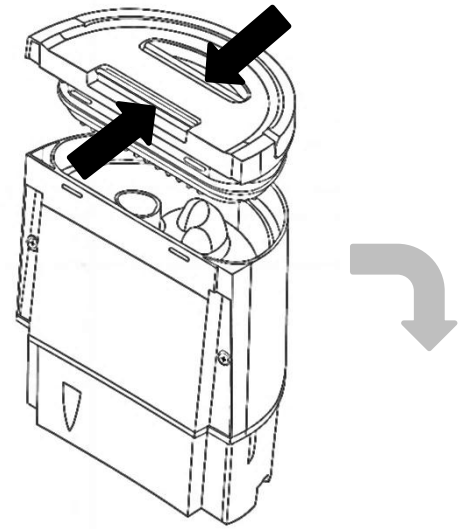

2. Remove the **Dirty Water Tank Lid (12)** by squeezing the catch in the lid inwards.

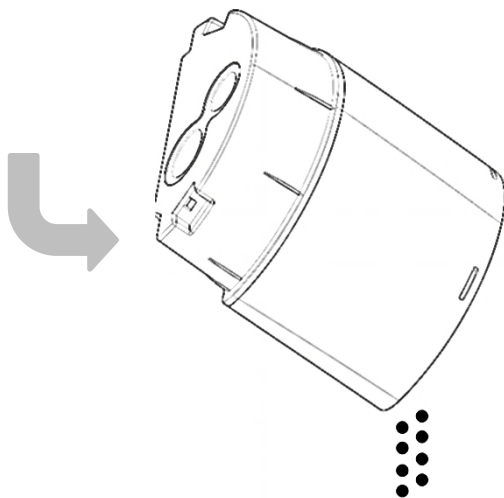

3. Pour out the contents.

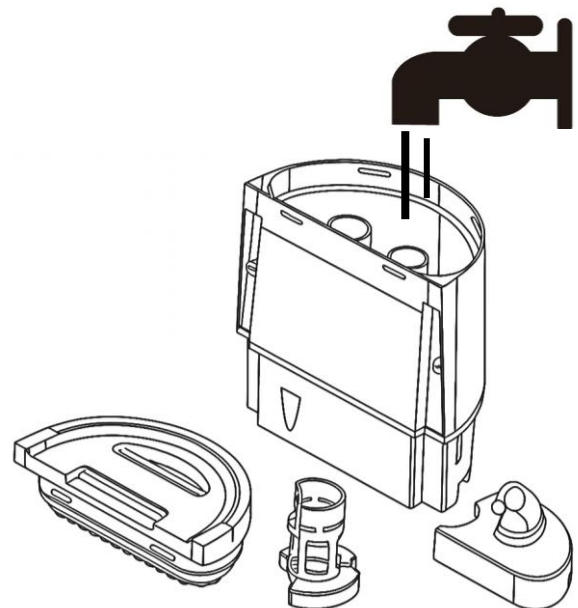

4. Wash the **Dirty Water Tank (10)** and the internal float components with warm water. Replace the float components and the **Dirty Water Tank Lid (12)** before refitting the tank back onto the Cleaner.

Cleaning & Maintenance of Your Spot & Upholstery Cleaner

⚠ WARNING! Always disconnect the spot cleaner from the mains supply before cleaning.

- Empty both water tanks after use ensuring that the **Dirty Water Tank (10)** has been cleaned as described above.
- Wipe the outside of the main body with a clean, soft cloth that has been soaked in warm water and gently wrung out.
- If there is any stubborn dirt or grime, apply a small amount of a gentle kitchen detergent to the cloth and wipe the area until it is clean. Thoroughly rinse the cloth and wipe the area again until no detergent residue remains.
- Do not submerge the appliance in water or any other liquids.

Cleaning the Water Tank Filter

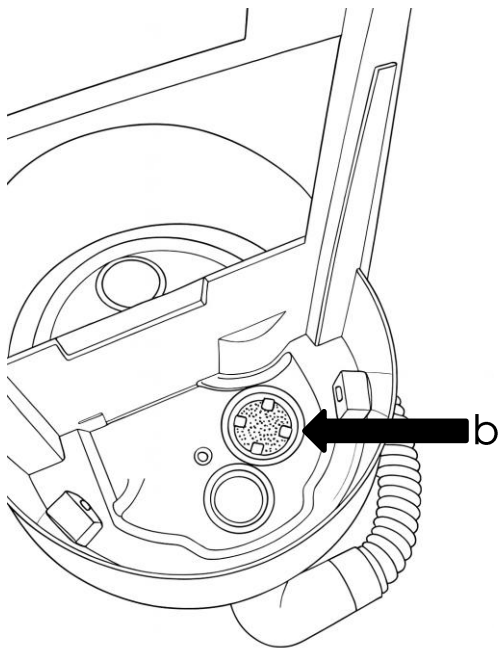

1. Remove the **Dirty Water Tank (10)**.
2. Remove the **Water Filter (b)**
3. Rinse the **Water Filter (b)** in warm running water until clean.
4. Allow the filter to dry thoroughly for 24 hours before refitting.

Cleaning & Maintenance of Your Spot & Upholstery Washer

Cleaning the Floor Tools

1. Remove the tool from the **Multitool** (5).

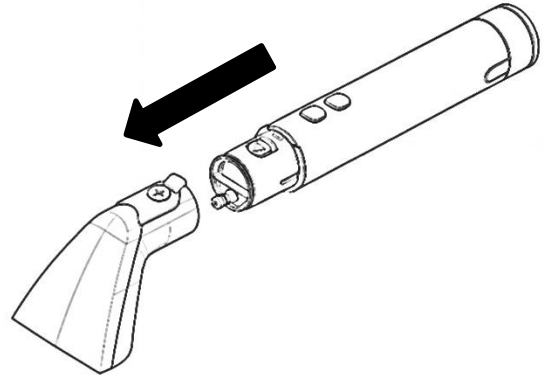

2. Lift the **Catch** (c) on the tool in the direction of the arrow shown right and dismantle the cleaning tool.

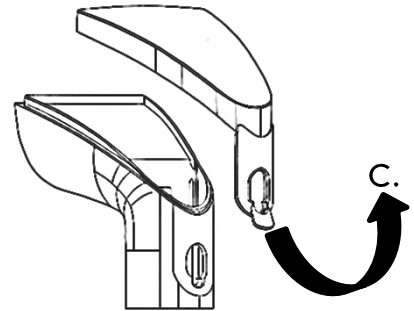

3. Thoroughly rinse the tool with water. Carefully remove any dirt and/or blockages.

4. Allow the tool to dry thoroughly for 24hrs before refitting it to the **Multitool** (5).

Using the Self Cleaning Attachment (27).

1. Remove the tool/brush being used from the **Multitool** (5) and attach the **Self Cleaning Attachment** (27) to the **Multitool** (5) shown below:

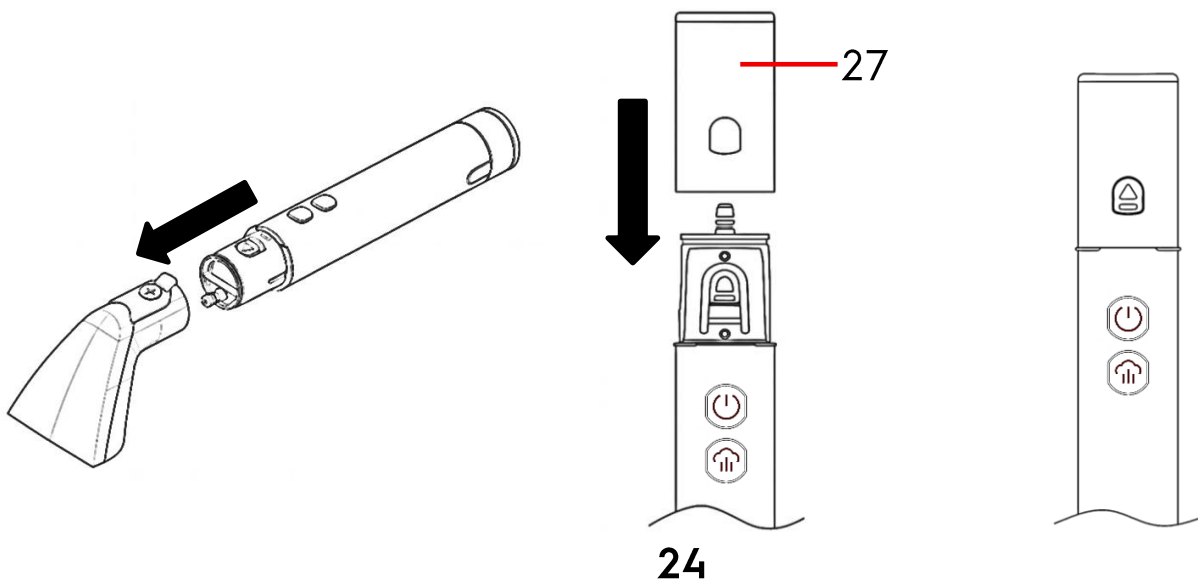

Cleaning & Maintenance of Your Spot & Upholstery Washer

2. Ensure the **Dirty Water Tank** (10) is empty and fill the **Clean Water Tank** (13) with water.

3. Insert the **Mains Plug** (6) into the nearest mains socket and switch the socket on (if applicable).

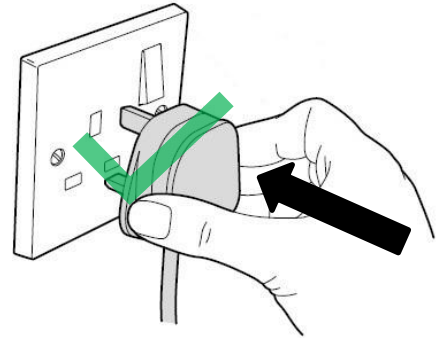

4. Touch the **Standby Button** (15) to power up the Spot and Upholstery Cleaner out of Standby and the **Control Panel** (1) will illuminate.

5. Touch the '**HIGH**' Button (18) on the **Control Panel** (1) to select the hot water cleaning mode.

6. Press the **Vacuum On/off Button** (9) to operate the vacuum. The LED indicator in the button will illuminate.

7. Let the water flow through the **Self Cleaning Attachment** (27) back into the hose and into the cleaner.

8. Run the Spot Cleaner until the **Clean Water Tank** (13) is empty and/or the hose is clean.

9. Repeat the above process if further cleaning is required

10. Remove the **Self Cleaning Attachment** (27) once the hose and cleaner have been cleaned.

NB There is intentionally a hole in the **Self Cleaning Attachment** (27).

Cleaning & Maintenance of Your Spot & Upholstery Washer

Cleaning the Outlet Filter

1. Once the Tanks are empty, turn the unit upside down.
2. Prise the catch (d) on the air outlet upwards and remove the air outlet cover

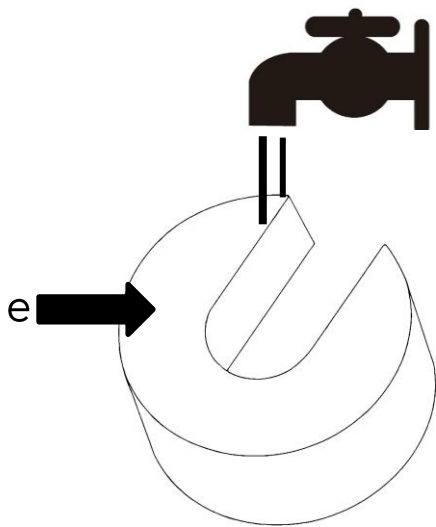
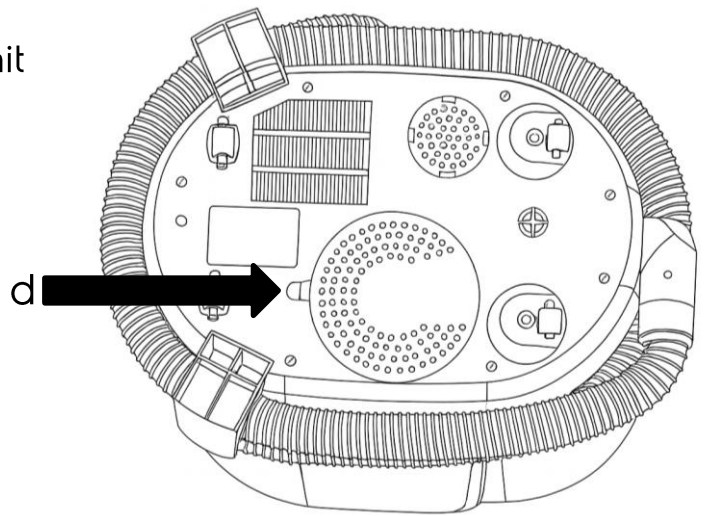

3. Wash the **Outlet Filter** (e) in warm running water until clean.
4. Allow the filter to dry thoroughly for 24 hours before refitting it to the cleaner.

Storing Your Spot & Upholstery Washer

1. Remove the **Mains Plug** (6) from the mains socket.

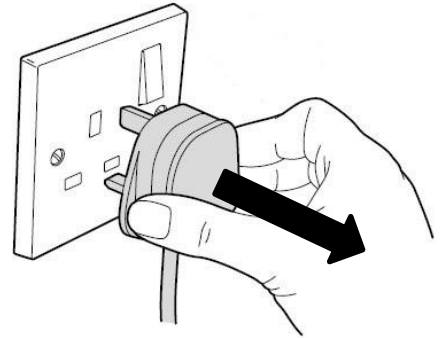

2. Press the **Mains Cable Rewind Button** (4) to retract the mains cable:
NB care should be used whilst rewinding the cable as the cable retracts at speed.

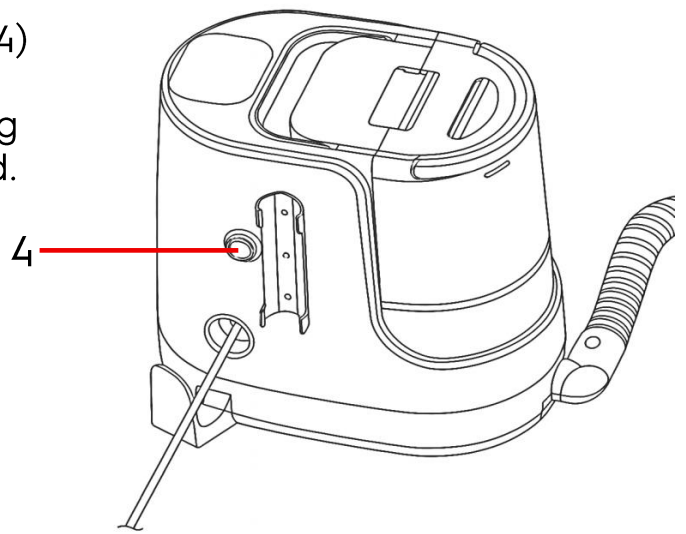

- **DO NOT** store the Spot Cleaner with water in either tank – rinse the tanks out and allow to thoroughly dry before storage.
- Store the Spot Cleaner in a cool, dry place away from direct sunlight.

Technical Specification

Model Number	FLR00213
Rated Voltage	220-240V AC ~ 50/60Hz
Rated Power	1700W
Protection Class	I – This product must be Earthed
Motor Power	400W
Clean Water Tank Capacity	1000ml (max.)
Dirty Water Tank Capacity	1500ml (max.)
Steam Flow Rate	20ml/min. (approx.)
Steam Temperature	99°C
IP Rating	IPX4
Weight (without accessories)	6kg
Dimensions	40.2cm (l) x 31.8cm (w) x 41.3cm (h)
ErP: Power consumption of equipment in standby mode shall not exceed 0.80W	0.77W
This equipment complies with Annex III of Commission Regulation (EU) 2023/826	

The LED Colour Bargraph

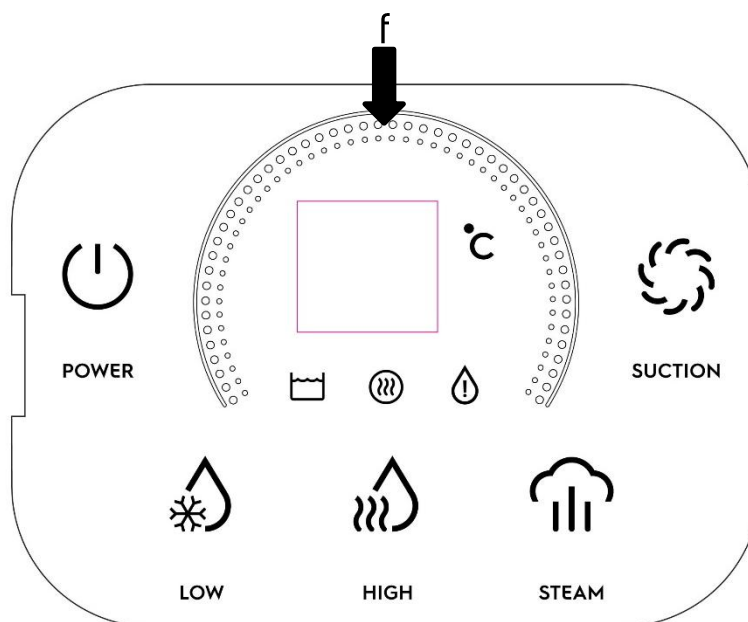

The **Colour LED Bargraph** (f) changes colour as the water temperature rises. At low temperatures the display is green, at warm temperatures orange and finally red for steam (99°C). Also, the Bargraph will show fully illuminated when the high suction speed is selected.

Troubleshooting Guide

Problem	Possible Cause	Solution
Unit fails to turn on.	The unit may not be properly plugged in.	Ensure the plug is fully inserted into the socket and that the socket is switched on.
	The fuse may have blown.	Check the fuse by substitution.
	The motor has overheated	Switch off and allow the unit to cool before reuse.
	The power is not switched on.	Touch the Standby Button
The appliance is not producing any spray.	The water tank is empty.	Fill the water tank with clean water.
	The vacuum hose is dirty or clogged.	Clean the vacuum hose
No Steam Being Produced	Incorrect Mode Selected	Select Steam Mode
Water produced is cold and not hot	Incorrect Mode Selected	Select High Heat Mode.
Low suction during cleaning.	The Dirty Water Tank is full.	Empty the Dirty Water Tank.
	The Dirty Water Tank is not installed properly.	Check the Dirty Water Tank is installed properly.
	Automatic suction stop device	Turn off the appliance and empty the dirty water tank.
	The vacuum hose is dirty, clogged	Clean the vacuum hose
	The filters are blocked	Clean the Filters



Should you require any product information, replacement parts or accessories, please contact our customer care team on 0161 831 7879 (8.30am-4.30pm Monday to Thursday, 8.00am-4.00pm Friday) and select option 3 or by contacting us via email:

help@electroluxsmalldomesticappliance.co.uk

- Replacement parts and accessories are guaranteed for 1 year from the date of purchase.
- It is important to note that your warranty becomes invalid should non Electrolux parts or accessories be used with this appliance.

Recycling Information

Disposal of the Packaging

Dispose of paper and cardboard in appropriate paper re-cycling facilities.
Dispose of recyclable plastics in appropriate plastic re-cycling facilities.
Dispose of non-recyclable plastics in the appropriate plastics collection service.

Disposal of the Product

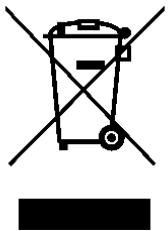

You should now recycle your waste electrical goods and in doing so help the environment. This symbol means waste electrical products at the end of their useful life should not be disposed of with normal household waste and not sent to landfill. Please ensure it is taken to a suitable facility for disposal. Check with your Local Authority or retailer for recycling advice or visit www.recycle-more.co.uk or www.weeeireland.ie, enter your postcode to find out your nearest recycling site.

Mains Plug Wiring Information

If your appliance is supplied with a non-rewireable plug fitted to the mains lead and should the fuse needed replacing, you must use an ASTA approved one (conforming to BS 1362 of the same rating). Never use a plug with the fuse cover missing. If in doubt, consult a qualified electrician.

If you need to remove the plug **-DISCONNECT FROM THE MAINS-** and then cut it off the mains lead and immediately dispose of it safely. Never attempt to reuse the plug or insert it into a socket outlet as there is a danger of electric shock.





Electrolux

WARRANTY

Thank you for purchasing your Electrolux Product.

As part of our commitment to quality, we are offering you an extra 4 years warranty in addition to your 1 year guarantee

Your Electrolux product is guaranteed for 1 year from the date of original purchase, with proof of purchase or receipt. If any defect should occur due to faulty workmanship or material, your faulty vacuum should be returned to the place of purchase, replacement or refund is at the discretion of the retailer.

The guarantee is subject to the following provisions:

- The product must be correctly installed and operated in accordance with the requirements contained in the instruction manual.
- The product must be used solely for domestic purposes.
- It does not cover general wear and tear, damage, misuse or any consumable parts.
- The guarantee will be rendered invalid if the product is re-sold or has been damaged through inexpert repair.
- The guarantee is only valid within the UK and Eire.

Your standard 1 year guarantee will only be extended to the maximum available for your individual product upon registration. (Note: products must be registered individually and covers the main body and housing). If you do not register your product within 28 days of the original purchase date, your product will only be guaranteed for 1 year.

To validate your extended 4 year warranty*please register your purchase online within 28 days of the original purchase date by registering at:

help@electroluxsmalldomesticappliance.co.uk

or

Contact Us: www.electroluxfloorcare-sda.co.uk

*Your extended warranty is only valid with proof of purchase receipt and subject to the conditions outlined above.

Produced and imported under licence by

Eurosonic Group Limited

Brightgate House

1 Brightgate Way

Manchester M32 0TB UK

EU Rep: EuroSonic Magpie (ESM) Ltd. Ireland D05 X006

www.esgltd.com

ELECTROLUX is a pending or registered trademark used under license from AB Electrolux (publ)