

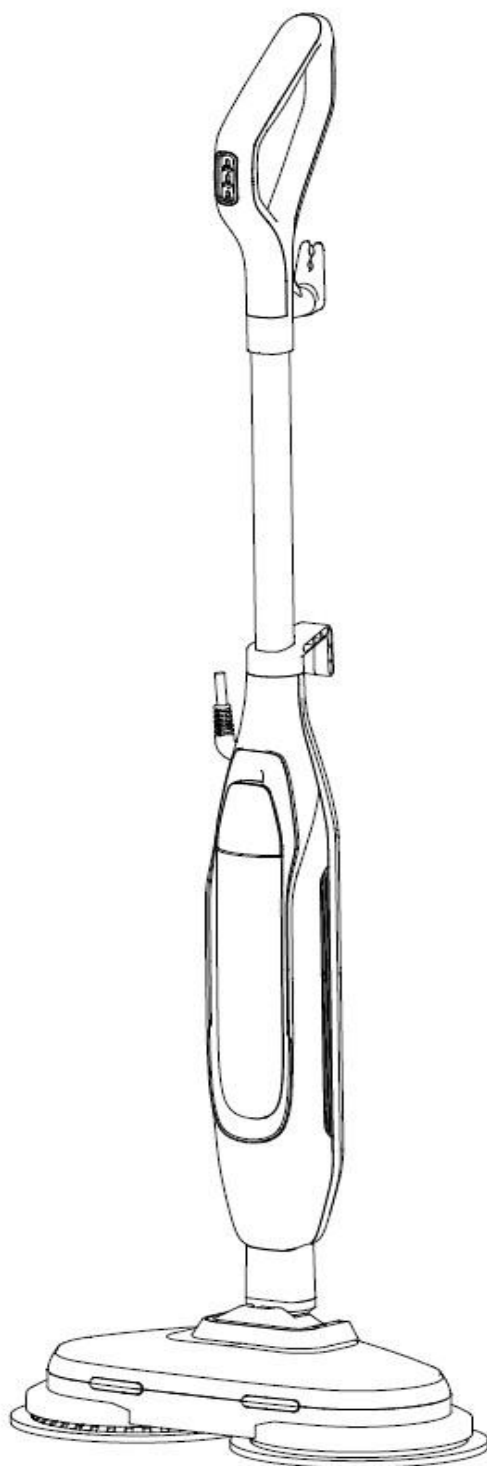

Electrolux



SPIN STEAM MOP
FLR00211

Contents

Page No.

2	Contents
3	Reading and Storing the User Manual
3	Important Safety Instructions for Proper Use
5	Explanation of Symbols
7	Description of Parts & Accessories
8	What's in the Box
9	Description of Parts – Spin Steam Mop
10	Description of Parts – The Control Panel
10	Before First Use of Your Spin Steam Mop
11	Assembling Your Spin Steam Mop – Attaching the Handle
12	Assembling Your Spin Steam Mop – Attaching the Cleaning Pads
12	Filling the Water Tank
13	Using Your Spin Steam Mop
14	Notes on Steam Cleaning
15	Cleaning & Maintenance of Your Spin Steam Mop
15	Replacement Cleaning Pads
15	Storing Your Spin Steam Mop
16	Technical Specification
16	Troubleshooting Guide
17	Customer Support
18	Recycling Information
18	Plug Wiring Information
19	FSC and Safety Marks
Back Page	Warranty Information

Reading and Storing the User Manual

Before using this product, please read through this manual paying careful attention to the safety instructions. Failure to do so may result in personal injury or damage to the product.

Carefully save this instruction manual for future reference. Ensure the user manual is included when passing the product on to any third parties.

Important Safety Instructions for Proper Use

When using electrical appliances, basic safety precautions should always be followed.

Only use the product as described in this user manual. Any other use is considered improper and may result in damage to property or persons.

The manufacturer or vendor cannot be held liable for damages or injury incurred through improper or incorrect use.

- **Read and familiarise yourself with all operating instructions before using this Spin Steam Mop.**
- Before plugging your unit into the mains, visually check that the unit is intact and has not suffered any transit damage.
- Check that the voltage indicated on the data plate corresponds with that of the local network before connecting the appliance to the mains power supply.
- This appliance can be used by persons with reduced physical, sensory or mental capabilities or lack of experience and knowledge if they have been given supervision or instruction concerning use of the appliance in a safe way and understand the hazards involved.



Important Safety Instructions for Proper Use

- Children shall not play with the appliance.
- Keep the appliance and its cord out of reach of children less than 8 years when it is energised or cooling down.
- **DO NOT** immerse the appliance or its cord in water or any other liquids.
- **DO NOT** leave the appliance unattended during use.
- **DO NOT** leave the appliance unattended whilst connected to the mains supply.
- **DO NOT** use this appliance outdoors.
- It is imperative to unplug the power cord after the appliance has been used, before it is cleaned and whilst being repaired.
- Repairs to electrical appliances should only be performed by a qualified electrician. Improper repairs may place user at serious risk.
- **DO NOT** operate this appliance with a damaged plug or cord, after a malfunction or after being dropped or damaged in any way.
- Regular, periodic checks should be carried out on the mains cable to ensure no damage is evident. Should there be any signs of damage the appliance should not be used.
- If the mains cable is damaged, it should only be replaced by qualified personnel in order to avoid a hazard
- **DO NOT** allow the mains cable to hang over sharp edges or come in contact with hot surfaces.
- **DO NOT** run the mains cable under carpets, rugs, etc.
- The Spin Steam Mop is not to be used if it has been dropped, if there are visible signs of damage or it is leaking.

Important Safety Instructions for Proper Use







- The plug must be removed from the socket outlet before the water tank is filled with water.
- The filling aperture must not be opened during use.
- Allow the unit to cool before storage.
- Before cleaning, disconnect the appliance from the mains supply and allow to cool.
- This appliance is intended for household use only and should not be used for industrial purposes.
- **DO NOT** use any accessories or attachments with this appliance other than those supplied or recommended by supplier.
- **DO NOT** use this appliance for anything other than its intended use.
- **DO NOT** push objects into any openings as damage to the appliance and/or electric shock may occur.
- Unplug after each use. Grasp the plug, not the cord.
- **DO NOT** direct steam at people, animals, electrical appliances or electrical socket outlets.
- Steam must not be directed towards equipment containing electrical components such as the interior of ovens.
- **DO NOT** pull or carry the Spin Steam Mop by the electrical cord.
- **DO NOT** use the Spin Steam Mop in enclosed spaces or spaces that may contain vapours given off by paint thinners, oil-based explosive or toxic vapours or flammable dust.
- Ensure that the Cleaning Pads are fitted correctly before use.
- **DO NOT** use the Spin Steam Mop without the Cleaning Pads fitted.

Important Safety Instructions for Proper Use

- **DO NOT** use on leather or wax polished furniture or floors, synthetic fabrics, velvet or other delicate or steam sensitive materials.
- **DO NOT** use on unsealed hard floor surfaces. Additionally, on surfaces that have been treated with wax or polish, the sheen may be removed by the action of the steam. It is always recommended to test an isolated area of the surface to be cleaned before proceeding. It is also recommended to check the care instructions from the floor manufacturer.
- **Caution:** Always wear suitable shoes when using the steam mop, do not wear slippers or open toed footwear.
- **Caution:** Keep hair, loose clothing, fingers, and all parts of body away from openings and moving parts.
- **Caution:** This Spin Steam Mop emits hot steam to sanitize the area being cleaned, this means that the cleaning pads get very hot during use and remain hot for some time after use.
- **Caution:** The steam emitted from the steam mop is very hot and may cause scalding. Please use caution whilst using this Spin Steam Mop.
- **DO NOT** carry the steam mop whilst in use.
- To prolong the life of the product it is recommended that distilled/demineralised water is used.
- In hard water areas only distilled/demineralised water must be used with this Spin Steam Mop.
- **DO NOT** scrub any one area for an extended period.
- **DO NOT** add chemicals or cleaning solutions (including vinegar) to the Water Tank, as damage may occur to the Spin Steam Mop.

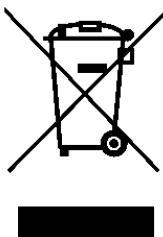
Explanation of Symbols

The following warning symbols or words are used in this instruction manual:

	<p>Products labelled with UK Conformity Assessment identifies products conforming to UK statutory requirements</p>
	<p>Products labelled with this symbol conform to applicable provisions of the European Economic Area.</p>
	<p>You should now recycle your waste electrical goods and in doing so help the environment. This symbol means waste electrical products at the end of their useful life should not be disposed of with normal household waste and not sent to landfill. Please ensure it is taken to a suitable facility for disposal. Check with your Local Authority or retailer for recycling advice or visit www.recycle-more.co.uk or www.weeeireland.ie enter your postcode to find out your nearest recycling site.</p>
	<p>This symbol indicates that the supply uses an alternating current mains supply.</p>
	<p>This designates a hazard with moderate risk, which may result in severe injury or damage to the product if not adhered to.</p>
	<p>This product is class 1 and must be Earthed.</p>



Electrolux

What's In the Box

- Spin Steam Mop Handle
- Spin Steam Mop Main Unit
- Two Cleaning Pads on unit.
- Two spare cleaning pads.
- Filling Cup
- Instruction Manual

Description of Parts – Steam Mop

1. Handle
2. Control Panel
3. Top Cable Hook
4. Handle Pole
5. Lower Cable Hook
6. Main Unit
7. Filling Cap
8. Water Tank
9. Motor Unit
10. Cleaning Pads

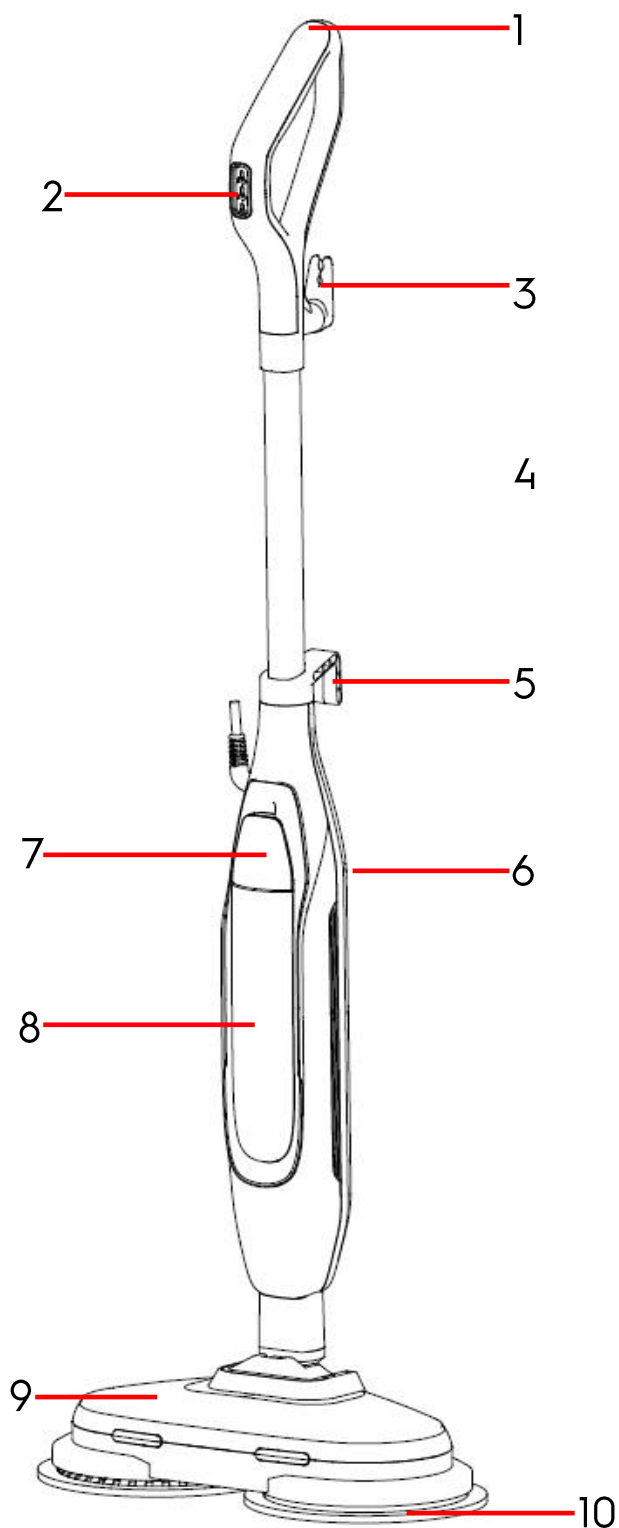

Description of Parts – The Control Panel (2)

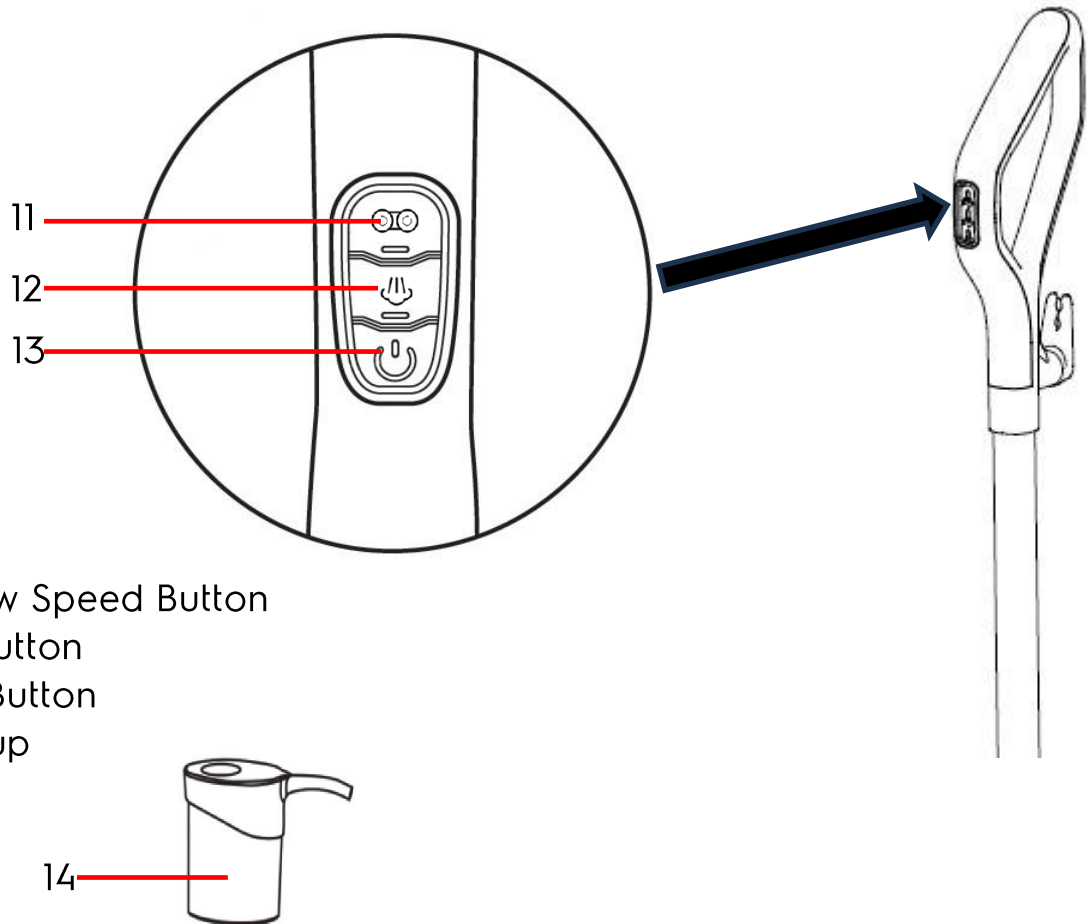

Before First Use of Your Spin Steam Mop

- Before use, retain all packaging until all the parts are present against the parts list – see **Description of Parts** above.
- Take care whilst opening the carton as a sharp blade may damage the product.
- After which discard packaging responsibly.

Assembling Your Spin Steam Mop – Attaching the Handle

⚠ WARNING! Before assembling the Spin Steam Mop, ensure that the mains plug is not inserted into the mains socket.

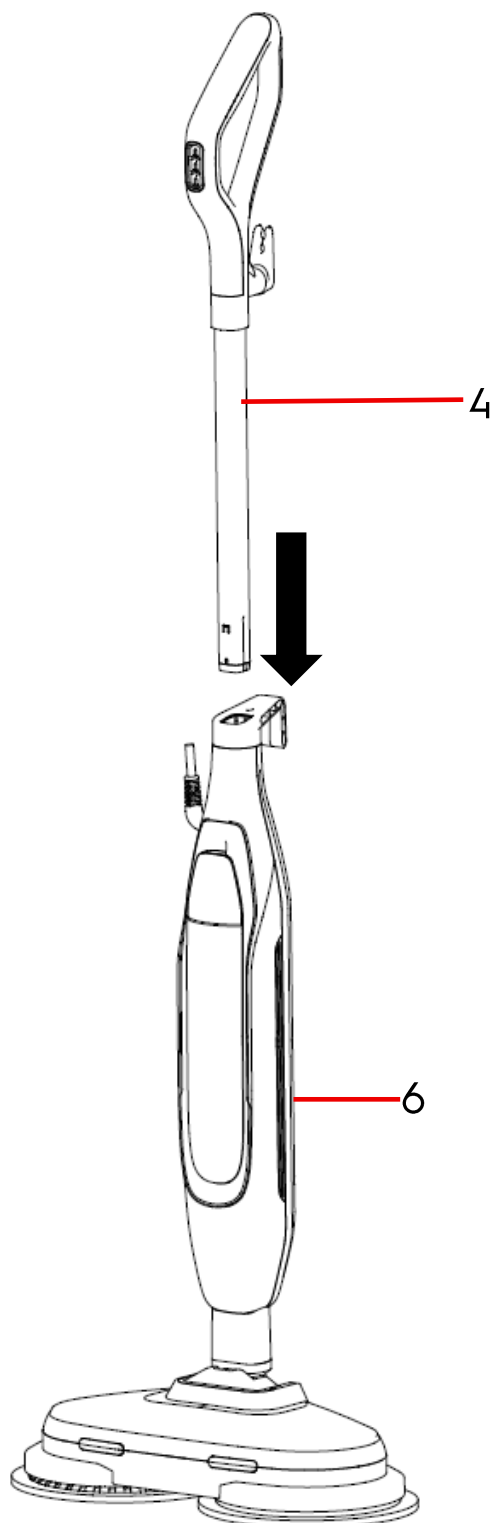

1. Push the **Handle Pole** (4) into the top of the **Main Unit** (6) until it clicks into place.

Assembling Your Spin Steam Mop – Attaching the Cleaning Pads

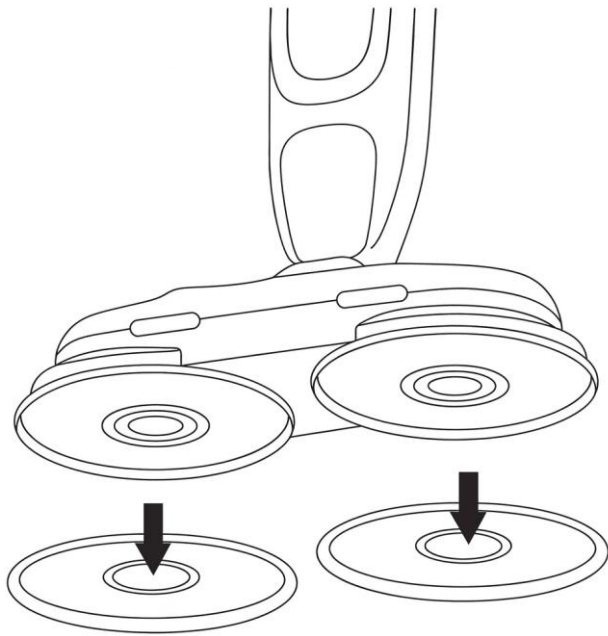

2. Align the plastic rings on the **Cleaning Pads** (10) with the gap around the two rotating discs on the base of the **Main Unit** (6) as shown left. Press the pads until secured in place.

Filling the Water Tank

1. Right: Lower the **Filling Cap** (7) on the front of the Spin Steam Mop.

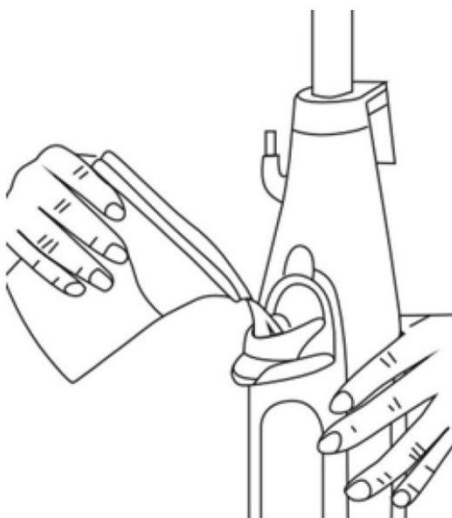

2. Left: Fill the **Water Tank** (8) using the **Filling Cup** (14) supplied, ensure that the water level does not exceed the 'MAX' mark.
3. Push the **Filling Cap** (7) closed.

NB *It is strongly recommended that Filtered/Demineralised water is used in hard water areas to maintain the efficiency and prolong the life of the product.

Using Your Spin Steam Mop

⚠ WARNING! DO NOT touch the Cleaning Pads during or just after use as hot steam is emitted from this product and scalding may occur.

1. Rotate the **Top Cable Hook** (3) downwards and remove the mains cable.

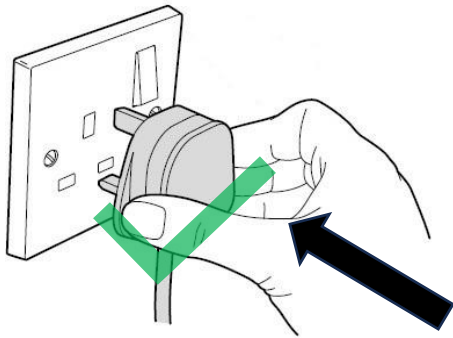
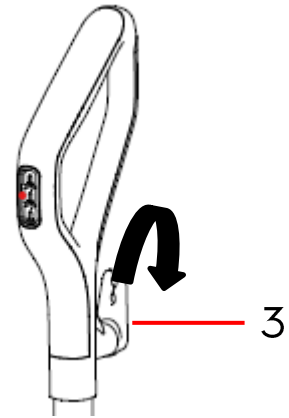

2. Fully unravel the mains cable and plug the steam mop into a suitable socket outlet and switch on (if applicable).

Powering Up

3. To power up the Steam Mop, first pull the steam mop back by the **Handle** (1) whilst placing your foot gently on the **Motor Unit** (9) so that the unit is no longer in the upright position. Press the **On/Off Button** (13) to power up the spin steam mop.

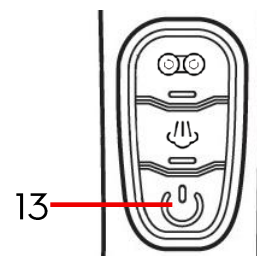

Generating Steam

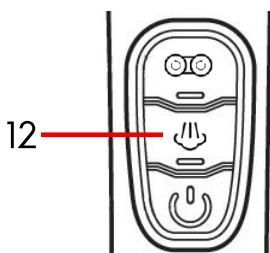

4. To enable the steam function, press the **Steam Button** (12). The light in the button will flash for approximately 30 seconds whilst the unit heats up. Once the light has stopped flashing, the unit will have heated up and steam will now be emitted.

Using Your Spin Steam Mop

Changing the Speed of the Cleaning Pads

5. Press the **High/Low Speed Button** (11) to change the rotating speed of the **Cleaning Pads** (10) from low to high. Press the button again to return to the low speed.

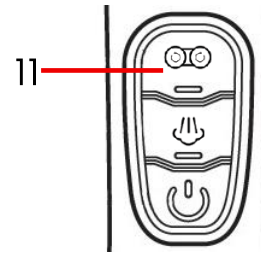

Notes on Steam Cleaning

The Spin Steam Mop is designed to clean many floor surfaces, such as ceramic, marble, carpet, stone, linoleum, vinyl, parquet and sealed hardwood floors.

Please be aware that some floor types are not suitable for steam cleaning and extra care is needed as follows:

- The heat and steam action may remove the wax on floor surfaces treated with wax.
- Do not use on unsealed flooring (e.g., unvarnished, unwaxed, bare wood floors).
- Do not allow the steam mop to stand on wood or heat sensitive floors for excessive periods of time as this will cause the wood grain to warp/split and damage the surface.
- Whilst cleaning vinyl, linoleum or any other heat sensitive floors, use extra caution as too much heat can melt the glue in flooring.
- Use only on laminated flooring that has been well laid without any gaps or cracks that would permit the entry of moisture.
- Before cleaning the floor test the steam mop on a small, isolated area of flooring prior to check for any damage.

⚠ WARNING! This Spin Steam Mop emits hot steam during use, care must be taken not to direct steam at people, animals, electrical appliances or electrical socket outlets.

Cleaning and Maintenance of Your Spin Steam Mop

After use, ensure the Spin Steam Mop is disconnected from the mains supply and is in the upright position and allowed to fully cool before cleaning.

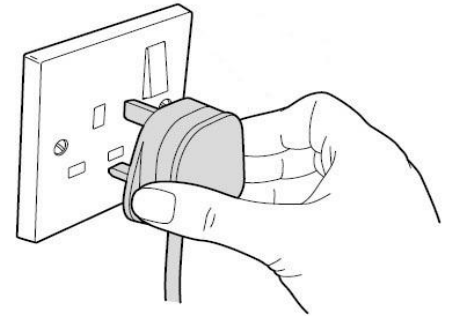

- Remove the Cleaning Pads once the appliance has cooled.
- Empty the water tank after every use by opening the Filling Cap and pouring into a sink.
- Do not immerse the appliance in water.
- Wipe the outside of the Spin Steam Mop with a clean damp cloth.
- **DO NOT** clean with Harsh or abrasive chemicals.
- **NEVER** use Bleach, Powdered Detergent or Fabric Softeners.

Replacement Cleaning Pads

Replacement microfibre pads are available by telephoning 0161 831 7879 and selecting option 3. Lines are open 8.30am-4.30pm Monday-Thursday, 8.00am – 4.00pm Friday or contact us via email:

help@electroluxsmalldomesticappliance.co.uk

Storing Your Spin Steam Mop

- **DO NOT** store the Spin Steam Mop with a damp Cleaning Pads attached.
- Place the Spin Steam Mop in the upright position, in a cool, dry place away from direct sunlight.

Technical Specification

Model Number	FLR00211
Rated Voltage	220-240V~ 50-60Hz
Rated Power	1500W
IP Rating	IPX4
Protection Class	I This product must be Earthed 
ErP: Power consumption of equipment in standby mode shall not exceed 0.50W	0.43W
This equipment complies with Annex III of Commission Regulation (EU) 2023/826	

Troubleshooting Guide

Problem	Possible Cause	Possible Solution
Unit fails to turn on.	The unit may not be properly plugged in.	Ensure the plug is fully inserted into the socket and the socket is switched on.
	The fuse in the plug may have blown	Check fuse by substitution.
	The fuse/circuit breaker may have tripped.	Check the fuse/circuit breaker on the mains board, if it has tripped, reset it.
	On/Off Button is not pressed.	Press the On/Off Button (13).
Low or no steam output	Water Tank is low or empty	Fill the Water Tank (8).
	Steam button not pressed	Press the Steam Button (12).
Spin Steam Mop cleaning slowly	Cleaning Pads on low speed	Press the High Speed Button (11).

Should you require any product information, replacement parts or accessories, please contact our customer care team on 0161 831 7879 (8.30am-4.30pm Monday to Thursday, 8.00am-4.00pm Friday) and select option 3 or by contacting us via email:

help@electroluxsmalldomesticappliance.co.uk

- Replacement parts and accessories are guaranteed for 1 year from the date of purchase.
- It is important to note that your warranty becomes invalid should non Electrolux parts or accessories be used with this appliance.

Recycling Information

Disposal of the Packaging

Dispose of paper and cardboard in appropriate paper re-cycling facilities.

Dispose of recyclable plastics in appropriate plastic re-cycling facilities.

Dispose of non-recyclable plastics in the appropriate plastics collection service.

Disposal of the Product

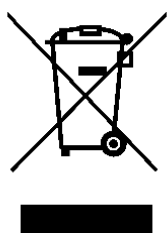

You should now recycle your waste electrical goods and in doing so help the environment. This symbol means waste electrical products at the end of their useful life should not be disposed of with normal household waste and not sent to landfill. Please ensure it is taken to a suitable facility for disposal. Check with your Local Authority or retailer for recycling advice or visit www.recycle-more.co.uk or www.weeeireland.ie enter your postcode to find out your nearest recycling site.

Mains Plug Wiring Information

If your appliance is supplied with a non-rewireable plug fitted to the mains lead and should the fuse needed replacing, you must use an ASTA approved one (conforming to BS 1362 of the same rating). Never use a plug with the fuse cover missing. If in doubt, consult a qualified electrician.

If you need to remove the plug **-DISCONNECT FROM THE MAINS-** and then cut it off the mains lead and immediately dispose of it safely. Never attempt to reuse the plug or insert it into a socket outlet as there is a danger of electric shock.

**UK
CA**

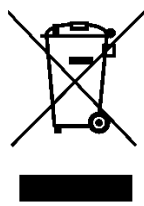



Electrolux

WARRANTY

Thank you for purchasing your Electrolux Product.

As part of our commitment to quality, we are offering you an extra 4 years warranty in addition to your 1 year guarantee

Your Electrolux product is guaranteed for 1 year from the date of original purchase, with proof of purchase or receipt. If any defect should occur due to faulty workmanship or material, your faulty vacuum should be returned to the place of purchase, replacement or refund is at the discretion of the retailer.

The guarantee is subject to the following provisions:

- The product must be correctly installed and operated in accordance with the requirements contained in the instruction manual.
- The product must be used solely for domestic purposes.
- It does not cover general wear and tear, damage, misuse or any consumable parts.
- The guarantee will be rendered invalid if the product is re-sold or has been damaged through inexpert repair.
- The guarantee is only valid within the UK and Eire.

Your standard 1 year guarantee will only be extended to the maximum available for your individual product upon registration. (Note: products must be registered individually and covers the main body and housing). If you do not register your product within 28 days of the original purchase date, your product will only be guaranteed for 1 year.

To validate your extended 4 year warranty*please register your purchase online within 28 days of the original purchase date by registering at:

help@electroluxsmalldomesticappliance.co.uk

or

Contact Us: www.electroluxfloorcare-sda.co.uk

*Your extended warranty is only valid with proof of purchase receipt and subject to the conditions outlined above.

Produced and imported under licence by
Eurosonic Group Limited
Brightgate House
1 Brightgate Way
Manchester M32 0TB UK

EU Rep: EuroSonic Magppie (ESM) Ltd. Ireland D05 X006
www.esgltd.com

ELECTROLUX is a pending or registered trademark used under
license from AB Electrolux (publ)